



Report of: **Service Director, Public Protection**

Meeting of	Date	Agenda Item	Ward(s)
Licensing Sub-Committee	22 nd January 2015		St. George's

Delete as appropriate		Non-exempt
-----------------------	--	------------

**Subject: PREMISES LICENCE VARIATION APPLICATION
CARDWELL NEWS, 6 CARDWELL TERRACE, LONDON, N7 0NH**

1. Synopsis

- 1.1 This is an application for the variation of a premise licence under the Licensing Act 2003.
- 1.2 The premises currently holds a licence allowing:
 - The sale by retail of alcohol, off supplies only, Mondays to Saturdays from 07:00 until 20:15 and Sundays from 08:00 until 15:15.
- 1.3 The variation application is to extend the hours for the sale of alcohol so as to allow:
 - The sale by retail of alcohol, off supplies only, Mondays to Sundays from 07:00 until 23:00.

2. Relevant Representations

Licensing Authority	No
Metropolitan Police	No
Noise	No
Health and Safety	No

Trading Standards	No
Public Health	No
Safeguarding Children	No
London Fire Brigade	No
Local residents	Yes: 1 local resident.
Other bodies	No:

3. Background

3.1 Papers are attached as follows:-

- Appendix 1: application form;
- Appendix 2: current premises licence;
- Appendix 3: representation;
- Appendix 4: suggested conditions and map of premises location.

3.2 Licensing History:

- 12th May 2011, premises licence application was granted by Licensing Sub-Committee. The licensee was, and remains, Mr Atul Shah.
- 24th October 2012, Mr Atul Shah also became the Designated Premises Supervisor.

4. Planning Implications

4.1 None.

5 Recommendations

5.1 To determine the application for a variation of the premises licence under Section 34 of the Licensing Act 2003.

5.2 If the Committee grants the application it should be subject to:

- i. conditions prepared by the Licensing Officer which are consistent with the Operating Schedule (see appendix 3)
- ii. any conditions deemed appropriate by the Committee to promote the four licensing objectives.(see appendix 3)
- iii. any conditions deemed necessary by the Committee to promote the four licensing objectives.

6 Conclusion and reasons for recommendations

6.1 The Council is required to consider this application in the light of all relevant information, and if approval is given, it may attach such conditions as appropriate to promote the licensing objectives.

Background papers:

The Council's Statement of Licensing Policy
Licensing Act 2003
Secretary of States Guidance

Final Report Clearance

Signed by

Service Director – Public Protection

Date 13/1/15

Received by

Head of Scrutiny and Democratic Services

Date

Report author: Licensing Service

Tel: 020 75027 3031

E-mail: licensing@islington.gov.uk

2014 68074
LN/13119



Islington
Application to vary a premises licence
Licensing Act 2003

For help contact
licensing@islington.gov.uk
Telephone: 020 7527 3031

* required information

Section 1 of 17

You can save the form at any time and resume it later. You do not need to be logged in when you resume.

System reference

Not Currently In Use

This is the unique reference for this application generated by the system.

Your reference

PREMISES-ISLINGTON-CARDWELL

You can put what you want here to help you track applications if you make lots of them. It is passed to the authority.

Are you an agent acting on behalf of the applicant?

Yes No

Put "no" if you are applying on your own behalf or on behalf of a business you own or work for.

Applicant Details

* First name

ATUL HIRJI VIRPAL

* Family name

SHAH

* E-mail

robertjordan01@btinternet.com

Main telephone number

01279 850753

Include country code.

Other telephone number

Indicate here if the applicant would prefer not to be contacted by telephone

Is the applicant:

- Applying as a business or organisation, including as a sole trader
 Applying as an individual

A sole trader is a business owned by one person without any special legal structure. Applying as an individual means the applicant is applying so the applicant can be employed, or for some other personal reason, such as following a hobby.

28 Brecknock Rd

IP2/290420
£190.00
25/11/14

Continued from previous page...

Address

* Building number or name

* Street

District

* City or town

County or administrative area

* Postcode

* Country

Agent Details

* First name

* Family name

* E-mail

Main telephone number Include country code.

Other telephone number

Indicate here if you would prefer not to be contacted by telephone

Are you:

- An agent that is a business or organisation, including a sole trader
- A private individual acting as an agent

A sole trader is a business owned by one person without any special legal structure.

Agent Business

* Is your business registered in the UK with Companies House? Yes No

* Registration number

* Business name If your business is registered, use its registered name.

* VAT number Put "none" if you are not registered for VAT.

* Legal status

* Your position in the business

Home country The country where the headquarters of your business is located.

Continued from previous page...

Agent Registered Address

Address registered with Companies House.

* Building number or name	PUMP HOUSE
* Street	OLD MEAD ROAD
District	HENHAM
* City or town	BISHOP'S STORTFORD
County or administrative area	HERTS
* Postcode	CM22 6JG
* Country	United Kingdom

Section 2 of 17

APPLICATION DETAILS

This application cannot be used to vary the licence so as to extend the period for which the licence has effect or to vary substantially the premises to which it relates. If you wish to make that type of change to the premises licence, you should make a new premises licence application under section 17 of the Licensing Act 2003.

I/we, as named in section 1, being the premises licence holder, apply to vary a premises licence under section 34 of the Licensing Act 2003 for the premises described in section 2 below.

* Premises Licence Number LN/13119-170613

Are you able to provide a postal address, OS map reference or description of the premises?

- Address OS map reference Description

Postal Address Of Premises

Building number or name	CARDWELL NEWS, 6
Street	CARDWELL TERRACE
District	
City or town	LONDON
County or administrative area	
Postcode	N7 0NH
Country	United Kingdom

Premises Contact Details

Telephone number	
Non-domestic rateable value of premises (£)	6,700

Section 3 of 17

VARIATION

Continued from previous page...

Do you want the proposed variation to have effect as soon as possible?

Yes No

Do you want the proposed variation to have effect in relation to the introduction of the late night levy?

Yes No

You do not have to pay a fee if the only purpose of the variation for which you are applying is to avoid becoming liable to the late night levy.

If your proposed variation would mean that 5,000 or more people are expected to attend the premises at any one time, state the number expected to attend

Describe Briefly The Nature Of The Proposed Variation

Describe the premises. For example the type of premises, its general situation and layout and any other information which could be relevant to the licensing objectives. Where your application includes off-supplies of alcohol and you intend to provide a place for consumption of these off-supplies, you must include a description of where the place will be and its proximity to the premises.

THE SALE BY RETAIL OF ALCOHOL FOR CONSUMPTION OFF THE PREMISES ONLY TO BE VARIED TO THE FOLLOWING HOURS:
MONDAY TO SUNDAY 07:00 HOURS TO 23:00 HOURS

Section 4 of 17

PROVISION OF PLAYS

Will the schedule to provide plays be subject to change if this application to vary is successful?

Yes No

Section 5 of 17

PROVISION OF FILMS

Will the schedule to provide films be subject to change if this application to vary is successful?

Yes No

Section 6 of 17

PROVISION OF INDOOR SPORTING EVENTS

Will the schedule to provide indoor sporting events be subject to change if this application to vary is successful?

Yes No

Continued from previous page...

Section 7 of 17

PROVISION OF BOXING OR WRESTLING ENTERTAINMENTS

Will the schedule to provide boxing or wrestling entertainments be subject to change if this application to vary is successful?

- Yes No

Section 8 of 17

PROVISION OF LIVE MUSIC

Will the schedule to provide live music be subject to change if this application to vary is successful?

- Yes No

Section 9 of 17

PROVISION OF RECORDED MUSIC

Will the schedule to provide recorded music be subject to change if this application to vary is successful?

- Yes No

Section 10 of 17

PROVISION OF PERFORMANCES OF DANCE

Will the schedule to provide performances of dance be subject to change if this application to vary is successful?

- Yes No

Section 11 of 17

PROVISION OF ANYTHING OF A SIMILAR DESCRIPTION TO LIVE MUSIC, RECORDED MUSIC OR PERFORMANCES OF DANCE

Will the schedule to provide anything similar to live music, recorded music or performances of dance be subject to change if this application to vary is successful?

- Yes No

Section 12 of 17

PROVISION OF LATE NIGHT REFRESHMENT

Will the schedule to provide late night refreshment be subject to change if this application to vary is successful?

- Yes No

Section 13 of 17

SUPPLY OF ALCOHOL

Will the schedule to supply alcohol be subject to change if this application to vary is successful?

- Yes No

Continued from previous page...

Standard Days And Timings

MONDAY

Start

End

Start

End

Provide timings in 24 hour clock (e.g., 16:00) and only give details for the days of the week when you intend the premises to be used for the activity.

TUESDAY

Start

End

Start

End

WEDNESDAY

Start

End

Start

End

THURSDAY

Start

End

Start

End

FRIDAY

Start

End

Start

End

SATURDAY

Start

End

Start

End

SUNDAY

Start

End

Start

End

Will the sale of alcohol be for consumption?

- On the premises Off the premises Both

If the sale of alcohol is for consumption on the premises select on, if the sale of alcohol is for consumption away from the premises select off. If the sale of alcohol is for consumption on the premises and away from the premises select both.

State any seasonal variations.

For example (but not exclusively) where the activity will occur on additional days during the summer months.

Continued from previous page...

Non-standard timings. Where the premises will be used for the supply of alcohol at different times from those listed above, list below.

For example (but not exclusively), where you wish the activity to go on longer on a particular day e.g. Christmas Eve.

Section 14 of 17

ADULT ENTERTAINMENT

Highlight any adult entertainment or services, activities, or other entertainment or matters ancillary to the use of the premises that may give rise to concern in respect of children.

Provide information about anything intended to occur at the premises or ancillary to the use of the premises which may give rise to concern in respect of children, regardless of whether you intend children to have access to the premises, for example (but not exclusively) nudity or semi-nudity, films for restricted age groups etc gambling machines etc.

NONE

Section 15 of 17

HOURS PREMISES ARE OPEN TO THE PUBLIC

Standard Days And Timings

MONDAY

Start

End

Start

End

Provide timings in 24 hour clock (e.g., 16:00) and only give details for the days of the week when you intend the premises to be used for the activity.

TUESDAY

Start

End

Start

End

WEDNESDAY

Start

End

Start

End

THURSDAY

Start

End

Start

End

FRIDAY

Start

End

Start

End

Continued from previous page...

SATURDAY

Start

End

Start

End

SUNDAY

Start

End

Start

End

State any seasonal variations.

For example (but not exclusively) where the activity will occur on additional days during the summer months.

Non standard timings. Where you intend to use the premises to be open to the members and guests at different times from those listed above, list below.

For example (but not exclusively), where you wish the activity to go on longer on a particular day e.g. Christmas Eve.

Identify those conditions currently imposed on the licence which you believe could be removed as a consequence of the proposed variation you are seeking.

- I have enclosed the premises licence
- I have enclosed the relevant part of the premises licence

Reasons why I have failed to enclose the premises licence or relevant part of premises licence.

Section 16 of 17

LICENSING OBJECTIVES

Describe the steps you intend to take to promote the four licensing objectives:

a) General – all four licensing objectives (b,c,d,e)

List here steps you will take to promote all four licensing objectives together.

Continued from previous page...

CCTV shall be installed with 31 day recording

There shall be on the premises at all times at least one person who is able to download copies when requested by an authorised officer of the police or licensing authority

CCTV shall be of a high standard recording images of person entering the premises of at least head and shoulders

CCTV cameras shall record alcohol display areas and point of sale

Staff training shall be recorded and updated every 4 months Training shall cover the requirements for ID as part of age verification, how to detect proxy sales, the consequences of underage sales (fines and punishment), and other relevant matters relating to the licensing objectives, and the responsibilities of staff.

The licence holder shall ensure that a refusals register is kept on the premises and that this shall be immediately available upon request of an authorised officer. The register shall record any refused sale (including intoxicated persons, under 18's).

The refusal register shall be inspected on a regular basis (at least weekly) by the DPS and signed by the DPS that they have checked the register

At least 12 months of refusal register details shall be retained and made available upon request by an authorised officer

An incident register shall be maintained recording all incidents of crime and disorder or other matters. The incident register shall be inspected on a regular basis (at least weekly) by the DPS and signed by the DPS that they have checked the register

There shall be a documented reporting structure back to the Designated Premises Supervisor (DPS) and premises licence

holder which shall include telephone contact numbers. This reporting document shall be immediately available upon request of an authorised officer

The premises licence holder shall ensure that a 'challenge 25' policy is adopted on the premises at all times. Signage of the 'challenge 25' policy shall be prominently displayed on the premises.

Acceptable identification accepted by the premises licence holder, DPS, or other staff members shall be a passport, photo driving licence or PASS accredited identity card

Signage shall be displayed in a prominent position on the premises requesting that customers leave quietly

Signage shall be prominently displayed warning customers of the legal penalties for purchasing alcohol for any person under the age of 18 years

NO ALCOHOL TO BE PURCHASED OTHER THAN FROM BONA FIDA WHOLESALERS OR BONA FIDA REPRESENTATIVES WHO PROVIDE ITEMISED INVOICES WITH DATE, ADDRESS AND VAT NUMBER SO THAT IT CAN BE ESTABLISHED WHERE ALCOHOL IS PURCHASED FROM. COPIES OF INVOICES TO BE KEPT AT THE PREMISES FOR INSPECTION OF ANY RESPONSIBLE AUTHORITY OR POLICE OR LICENCING OFFICERS.

b) The prevention of crime and disorder

AS ABOVE IN A)

c) Public safety

AS ABOVE IN A)

d) The prevention of public nuisance

AS ABOVE IN A)

e) The protection of children from harm

Continued from previous page...

AS ABOVE IN A)

Section 17 of 17

PAYMENT DETAILS

This fee must be paid to the authority. If you complete the application online, you must pay it by debit or credit card.

Variation Fees are determined by the non domestic rateable value of the premises.

To find out a premises non domestic rateable value go to the Valuation Office Agency site at http://www.voa.gov.uk/business_rates/index.htm

Band A - No RV to £4300	£100.00
Band B - £4301 to £33000	£190.00
Band C - £33001 to £87000	£315.00
Band D - £87001 to £125000	£450.00*
Band E - £125001 and over	£635.00*

*If the premises rateable value is in Bands D or E and the premises is primarily used for the consumption of alcohol on the premises then your are required to pay a higher fee

Band D - £87001 to £125000	£900.00
Band E - £125001 and over	£1,905.00

If you own a large premise you are subject to additional fees based upon the number in attendance at any one time

Capacity 5000-9999	£1,000.00
Capacity 10000 -14999	£2,000.00
Capacity 15000-19999	£4,000.00
Capacity 20000-29999	£8,000.00
Capacity 30000-39999	£16,000.00
Capacity 40000-49999	£24,000.00
Capacity 50000-59999	£32,000.00
Capacity 60000-69999	£40,000.00
Capacity 70000-79999	£48,000.00
Capacity 80000-89999	£56,000.00
Capacity 90000 and over	£64,000.00

* Fee amount (£)

DECLARATION

* I/we understand it is an offence, liable on conviction to a fine up to level 5 on the standard scale, under section 158 of the licensing act 2003, to make a false statement in or in connection with this application.

Ticking this box indicates you have read and understood the above declaration

This section should be completed by the applicant, unless you answered "Yes" to the question "Are you an agent acting on behalf of the applicant?"

* Full name

* Capacity

Continued from previous page...

* Date

25	/	11	/	2014
dd		mm		yyyy

Add another signatory

Once you're finished you need to do the following:

1. Save this form to your computer by clicking file/save as...

2. Go back to <https://www.gov.uk/apply-for-a-licence/premises-licence/islington/change-1> to upload this file and continue with your application.

Don't forget to make sure you have all your supporting documentation to hand.

IT IS AN OFFENCE, LIABLE ON SUMMARY CONVICTION TO A FINE NOT EXCEEDING LEVEL 5 ON THE STANDARD SCALE, UNDER SECTION 158 OF THE LICENSING ACT 2003, TO MAKE A FALSE STATEMENT IN OR IN CONNECTION WITH THIS APPLICATION

OFFICE USE ONLY

Applicant reference number	PREMISES-ISLINGTON-CARDWELL
Fee paid	
Payment provider reference	
ELMS Payment Reference	
Payment status	
Payment authorisation code	
Payment authorisation date	
Date and time submitted	
Approval deadline	
Error message	
Is Digitally signed	<input type="checkbox"/>

< Previous 1 2 3 4 5 6 7 8 9 10 11 12 13 14 15 16 17 Next >



PREMISES LICENCE LICENSING ACT 2003

Premises licence number	LN/13119-170613		
Postal address of premises, or if none, ordnance survey map reference or description			
CARDWELL NEWS 6 CARDWELL TERRACE			
Post town	LONDON	Post code	N7 0NH
Telephone number			

Where the licence is time limited the dates
Not Applicable

Please note, some or all of the below licensable activities and the times the premises may carry out those licensable activities are currently restricted as a result of outstanding conditions as laid out in Annex 2 of this Premises Licence.

Licensable activities authorised by the licence
Ground floor
<ul style="list-style-type: none">The sale by retail of alcohol

The times the licence authorises the carrying out of licensable activities																												
<ul style="list-style-type: none">The sale by retail of alcohol: <table><tr><td>Monday</td><td>07:00</td><td>to</td><td>20:15</td></tr><tr><td>Tuesday</td><td>07:00</td><td>to</td><td>20:15</td></tr><tr><td>Wednesday</td><td>07:00</td><td>to</td><td>20:15</td></tr><tr><td>Thursday</td><td>07:00</td><td>to</td><td>20:15</td></tr><tr><td>Friday</td><td>07:00</td><td>to</td><td>20:15</td></tr><tr><td>Saturday</td><td>07:00</td><td>to</td><td>20:15</td></tr><tr><td>Sunday</td><td>08:00</td><td>to</td><td>15:15</td></tr></table>	Monday	07:00	to	20:15	Tuesday	07:00	to	20:15	Wednesday	07:00	to	20:15	Thursday	07:00	to	20:15	Friday	07:00	to	20:15	Saturday	07:00	to	20:15	Sunday	08:00	to	15:15
Monday	07:00	to	20:15																									
Tuesday	07:00	to	20:15																									
Wednesday	07:00	to	20:15																									
Thursday	07:00	to	20:15																									
Friday	07:00	to	20:15																									
Saturday	07:00	to	20:15																									
Sunday	08:00	to	15:15																									

Gaming Machine Provision:
Not authorised

The opening hours of the premises:																												
<table><tr><td>Monday</td><td>07:00</td><td>to</td><td>20:15</td></tr><tr><td>Tuesday</td><td>07:00</td><td>to</td><td>20:15</td></tr><tr><td>Wednesday</td><td>07:00</td><td>to</td><td>20:15</td></tr><tr><td>Thursday</td><td>07:00</td><td>to</td><td>20:15</td></tr><tr><td>Friday</td><td>07:00</td><td>to</td><td>20:15</td></tr><tr><td>Saturday</td><td>07:00</td><td>to</td><td>20:15</td></tr><tr><td>Sunday</td><td>08:00</td><td>to</td><td>15:15</td></tr></table>	Monday	07:00	to	20:15	Tuesday	07:00	to	20:15	Wednesday	07:00	to	20:15	Thursday	07:00	to	20:15	Friday	07:00	to	20:15	Saturday	07:00	to	20:15	Sunday	08:00	to	15:15
Monday	07:00	to	20:15																									
Tuesday	07:00	to	20:15																									
Wednesday	07:00	to	20:15																									
Thursday	07:00	to	20:15																									
Friday	07:00	to	20:15																									
Saturday	07:00	to	20:15																									
Sunday	08:00	to	15:15																									

Where the licence authorises supplies of alcohol whether these are on and/or off supplies
Off supplies

Name, (registered) address, telephone number and e-mail (where relevant) of holder of premises licence

Mr Atul Hirji Virpal Shah
2 Ashmed
Chase Road
Southgate
London
N14 4QX

Registered number of holder, for example company number, charity number (where applicable)

Name, address and telephone number of designated premises supervisor where the premises licence authorises the supply of alcohol

Mr Atul Hirji Virpal Shah

Personal licence number and issuing authority of personal licence held by designated premises supervisor where the premises licence authorises the supply of alcohol

Islington Council
Public Protection Division
222 Upper Street
London N1 1XR
Tel: 020 7527 3031
Email: licensing@islington.gov.uk

Service Manager - Commercial

Date of Issue

Annex 1 - Mandatory conditions

1. No supply of alcohol may be made under the premises licence:
 - a) at a time when there is no designated premises supervisor in respect of the premises licence, or
 - b) at a time when the designated premises supervisor does not hold a personal licence or his personal licence is suspended.
2. Every supply of alcohol under the premises licence must be made or authorised by a person who holds a personal licence.
3. The premises licence holder or club premises certificate holder shall ensure that an age verification policy applies to the premises in relation to the sale or supply of alcohol.

The policy must require individuals who appear to the responsible person to be under 18 years of age (or such older age as may be specified in the policy) to produce on request, before being served alcohol, identification bearing their photograph, date of birth and a holographic mark.

Annex 2 - Conditions consistent with the Operating Schedule

1. The premises shall not be used under the licence until the requirements specified in the schedule dated 12 April 2011 have been completed and approved in writing by the responsible authority for health and public safety.
2. CCTV shall be installed, operated and maintained in agreement with the Police. The system will enable frontal identification of every person entering the premises. The system shall record in real time and operate whilst the premises are open for licensable activities. The recordings shall be kept available for a minimum of 31 days. Recordings shall be made available to an Authorised Officer or a Police Officer (subject to the Data Protection Act 1998) within 24 hours of any request.
3. The licensee shall put arrangements in place to ensure that accredited proof of age cards e.g. Citizencard, a Passport, or UK Driving Licence bearing the photograph and date of birth of the bearer are used to confirm age.
4. The licensee and staff should note any refusals to sell to young people in a refusals log.
5. Staff shall be trained about age restricted products at six monthly intervals. A record of this training shall be kept.

Annex 3 - Conditions attached after a hearing by the licensing authority

1. Any persons who appears to be under 25 shall be asked to provide proof of age.

Annex 4 – Plans

Reference Number: LN/13119-120511-Plan



Premises Licence Summary

Licensing Act 2003

Premises licence number	LN/13119-170613		
Postal address of premises, or if none, ordnance survey map reference or description			
CARDWELL NEWS 6 CARDWELL TERRACE			
Post town	LONDON	Post code	N7 0NH
Telephone number			

Where the licence is time limited the dates
Not Applicable

Please note, some or all of the below licensable activities and the times the premises may carry out those licensable activities are currently restricted as a result of outstanding conditions as laid out in Annex 2 of this Premises Licence.

Licensable activities authorised by the licence
Ground floor
<ul style="list-style-type: none">The sale by retail of alcohol

The times the licence authorises the carrying out of licensable activities																												
<ul style="list-style-type: none">The sale by retail of alcohol: <table><tr><td>Monday</td><td>07:00</td><td>to</td><td>20:15</td></tr><tr><td>Tuesday</td><td>07:00</td><td>to</td><td>20:15</td></tr><tr><td>Wednesday</td><td>07:00</td><td>to</td><td>20:15</td></tr><tr><td>Thursday</td><td>07:00</td><td>to</td><td>20:15</td></tr><tr><td>Friday</td><td>07:00</td><td>to</td><td>20:15</td></tr><tr><td>Saturday</td><td>07:00</td><td>to</td><td>20:15</td></tr><tr><td>Sunday</td><td>08:00</td><td>to</td><td>15:15</td></tr></table>	Monday	07:00	to	20:15	Tuesday	07:00	to	20:15	Wednesday	07:00	to	20:15	Thursday	07:00	to	20:15	Friday	07:00	to	20:15	Saturday	07:00	to	20:15	Sunday	08:00	to	15:15
Monday	07:00	to	20:15																									
Tuesday	07:00	to	20:15																									
Wednesday	07:00	to	20:15																									
Thursday	07:00	to	20:15																									
Friday	07:00	to	20:15																									
Saturday	07:00	to	20:15																									
Sunday	08:00	to	15:15																									

Gaming Machine Provision:
Not authorised

The opening hours of the premises:																												
<table><tr><td>Monday</td><td>07:00</td><td>to</td><td>20:15</td></tr><tr><td>Tuesday</td><td>07:00</td><td>to</td><td>20:15</td></tr><tr><td>Wednesday</td><td>07:00</td><td>to</td><td>20:15</td></tr><tr><td>Thursday</td><td>07:00</td><td>to</td><td>20:15</td></tr><tr><td>Friday</td><td>07:00</td><td>to</td><td>20:15</td></tr><tr><td>Saturday</td><td>07:00</td><td>to</td><td>20:15</td></tr><tr><td>Sunday</td><td>08:00</td><td>to</td><td>15:15</td></tr></table>	Monday	07:00	to	20:15	Tuesday	07:00	to	20:15	Wednesday	07:00	to	20:15	Thursday	07:00	to	20:15	Friday	07:00	to	20:15	Saturday	07:00	to	20:15	Sunday	08:00	to	15:15
Monday	07:00	to	20:15																									
Tuesday	07:00	to	20:15																									
Wednesday	07:00	to	20:15																									
Thursday	07:00	to	20:15																									
Friday	07:00	to	20:15																									
Saturday	07:00	to	20:15																									
Sunday	08:00	to	15:15																									

Where the licence authorises supplies of alcohol whether these are on and/or off supplies
Off supplies

Name, (registered) address, telephone number and e-mail (where relevant) of holder of premises licence

Mr Atul Hirji Virpal Shah
2 Ashmed
Chase Road
Southgate
London
N14 4QX

Registered number of holder, for example company number, charity number (where applicable)

Name of designated premises supervisor where the premises licence authorises the supply of alcohol

Mr Atul Hirji Virpal Shah

State whether access to the premises by children is restricted or prohibited

No restrictions

Islington Council
Public Protection Division
222 Upper Street
London N1 1XR
Tel: 020 7527 3031
Email: licensing@islington.gov.uk

**PREMISES: CARDWELL NEWS, CARDWELL
TERRACE,
CARDWELL ROAD, HOLLOWAY, LONDON, N7 0NH
ENTRANCE AND FIRE EXIT**

89CM WIDTH

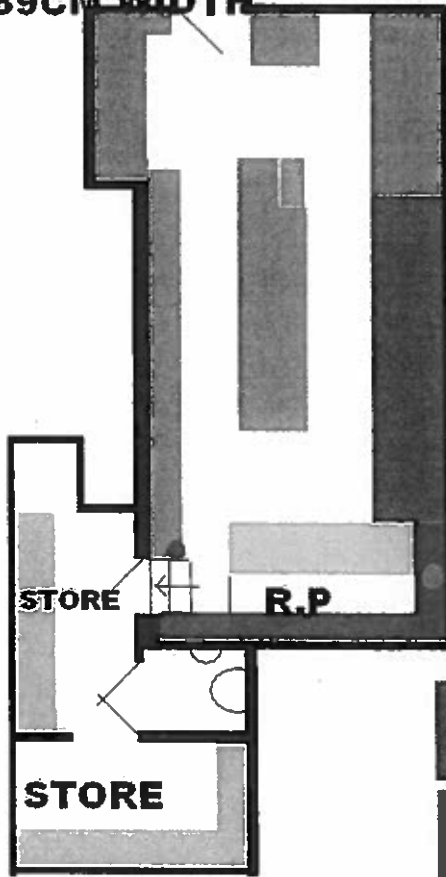

REF: LN/13119-120511-PLAN

-  **INITIAL ALCOHOL DISPLAY**
-  **ALCOHOL, CIGARETTES AND GENERAL GOODS**
-  **COUNTER**
-  **R.P. RAISED PLATFORM**
-  **GENERAL GOODS**
-  **STORE SHELVING**
-  **SECURITY SHUTTERS**
-  **CCTV**
-  **FIRE EXTINGUISHERS
1X 2KG CO2 1 X 2KG
POWDER**

SCALE 1:100

①

Sender, Yesim

From:
Sent: 23 December 2014 11:09
To: Licensing
Cc:
Subject: WK/2014 68074 Objection
Attachments: Islington_Ref_WK2014_68074_23122014.pdf

Dear Licensing Service,

Ref: WL/2014 68074

My name is _____ and I live at _____

Having been working away for the last couple of months, I returned to the UK a couple of days ago. Going through my mail this morning (23/12/2014) I found a License Application for extension of trading hours for Cardwell News. As one of the objectors at the original licensing hearing, I am surprised that this application has been submitted as we were assured when the license granted that this was limited to the sale of alcohol in a small portion of the shop during it's opening hours (upto 8pm) and I feel that the application for extended hours will only lead to a further extension down the line for this to be a full off license.

As I have been unable to submit my documentation on-line I have had to handwrite the response which is attached as a PDF. Should you have any difficulty reading the attached, below is a typed version of what is on the attached form:

Public Nuisance

As a quiet residential street, a late night premises will attract people from outside the immediate streets (Chambers, Tabley, Crayford, Bardolph and Cardwell) with the possibility of consuming alcohol directly outside the premises where it is sheltered by a tree and dim street lighting. There will also be a rise in noise from people coming and going into the shop until 11pm and then noise of the shop being locked up and shutters coming down.

Crime and Disorder

Due to the quiet location of the premises and the lack of police presence, drug dealing already takes place regularly as well as car break-ins. The police have been informed but there is still no police presence therefore having the premises licensed so late, this will provide an excuse for people to come down the street without arising suspicion.

Public Safety

As the surrounding streets are badly lit, having people who may consume alcohol in the street could cause a public safety issue for people returning home late at night.

I will be away again from 3rd January 2015 so will be unable to attend the hearing should it fall after this date. I would however like to be represented and ask that I can skype in for this hearing. Can you also please advise me via email of any hearing at _____. Although I have to go away to _____

work due to limited work opportunities for me in the UK at the moment, I am heavily invested in Islington and particularly the St George's Ward, where I have lived for 18 years.

I have copied my local councillors in on this correspondence in order to keep them informed of this objection ensure that it is considered as they know the area very well.

Finally I would like to advise you that my dog barks at excessive noise and, after 8pm, there is limited noise in the area. If this extension is granted and there is an increase in noise, I am putting Islington Council on notice that I cannot be held responsible for increased barking.

I hope that you view this correspondence favourably and consider the objection as part of the application for Cardwell News (note the name of the shop Cardwell News not Cardwell Beer, Wine and Spirits!).

Please confirm receipt of this email.

Thanking you in advance for your consideration.

Licensing Act 2003 representation pro-forma

Should you wish to comment on the licence application please use this form to help you. Please feel free to attach additional sheets.

You do not have to make any comment, and comments may be made in support of as well as against the application, providing they refer to one or more of the licensing objectives (please see the guidance notes for further advice).

Premises Name and address:

Cardwell News, 6 Cardwell Terrace, Islington, London, N7 0NH

Your Name:

Interest:

Resident

(E.g. resident, business, TRA Chair, Councillor, solicitor)

Your Address:

E-mail:

Telephone:

Please comment on the licensing objectives below relevant to your concerns or observations, you may also wish to include suggestions how your concerns could be addressed:

Public Nuisance As a quiet residential street, a late night premises will attract people from outside the immediate streets (Chambers, Sabley, Crayford, Bowdolph & Larchet) with the possibility of consuming alcohol directly outside the premises where it is sheltered by a tree and other street lighting. There will also be a rise in noise from people coming and going into the shop until 11pm when the noise of the shop being locked up settles coming down.

Crime and Disorder

Due to the quiet location of the premises and the lack of police presence, drug dealing already takes place regularly as well as car break-ins. The police have been informed but there is still no police presence therefore having the premises licensed so late, this will provide an excuse for people to come down the street without arising suspicion.

Protection of Children from Harm

Public Safety

As the surrounding streets are badly lit having people who may consume alcohol in the street could cause a public safety issue for people returning home late at night.

I wish my identity to be kept anonymous:

Yes No

We will treat representations as anonymous where there is a genuine reason to do so; if you wish your name and address details to be withheld then please explain the reason:

Copies of this representation will be sent to the applicant, or their agent/solicitor, including name and address details (but other personal contact information such as telephone numbers and email addresses will be removed) unless you have specifically requested anonymity. Copies of this representation will be included in a report that will be available to the public and will be published on the internet; however the published on-line version of the report will have name and address details removed.

Signa

Date:

26/12/2014

Please ensure name and address details completed above

Return to:

Licensing Service
London Borough of Islington
3rd Floor
222 Upper Street
London N1 1XR

or send by email to:

licensing@islington.gov.uk

Suggested conditions of approval consistent with the operating schedule

1. CCTV shall be installed with 31 day recording.
2. There shall be on the premises at all times at least one person who is able to download CCTV copies when requested by an authorised officer of the Police or Licensing Authority.
3. CCTV shall be of a high standard, recording images of every person entering the premises showing at least their head and shoulders.
4. CCTV cameras shall record alcohol display areas and point of sale.
5. Staff training shall be recorded and updated every four months. Training shall cover the requirements for ID as part of age verification, how to detect proxy sales, the consequences of underage sales (fines and punishment), and other relevant matters relating to the Licensing Objectives as well as the responsibilities of staff.
6. The licence holder shall ensure that a refusals register is kept on the premises and that this shall be immediately available upon the request of an authorised officer. The register shall record any refused sale (including intoxicated persons and under 18's).
7. The refusal register shall be inspected on a regular basis (at least weekly) by the DPS and signed by the DPS to show that they have checked it.
8. At least 12 months of refusal register details shall be retained and made available upon request by an authorised officer.
9. An incident register shall be maintained, recording all incidents of crime and disorder or other matters. The incident register shall be inspected on a regular basis (at least weekly) by the DPS and signed by the DPS to show that they have checked it.
10. There shall be a documented reporting structure back to the Designated Premises Supervisor and premises licence holder which shall include telephone contact numbers. This reporting document shall be immediately available upon request of an authorised officer.
11. The premises licence holder shall ensure that a 'Challenge 25' policy is adopted on the premises at all times. Signage of the 'Challenge 25' policy shall be prominently displayed on the premises.
12. Acceptable identification accepted by the premises licence holder, DPS, or other staff members shall be a Passport, Photo Driving Licence or PASS accredited identity card.
13. Signage shall be displayed in a prominent position on the premises requesting that customers leave quietly.
14. Signage shall be prominently displayed warning customers of the legal penalties for purchasing alcohol for any person under the age of 18 years.
15. No alcohol to be purchased other than from bona fida wholesalers or bona fida representatives who provide itemised invoices with date, address and VAT number so that it can be established where alcohol was purchased from. Copies of invoices to be kept at the premises for inspection by any responsible authority, Police officer or licensing officer upon request.

Whitton, Daniel

From: ROBERT JORDAN <robertjordan01@btinternet.com>
Sent: 05 January 2015 15:28
To: Whitton, Daniel; Licensing
Subject: 261 Holloway Road Cardwell News

Hello dan,

I will represent the licence holder at the review hearing for 261 Holloway Road on 8th January 18:30 hours.

The licence Holder will attend.

Also I will represent the Licence holder for Cardwell news and they will attend the hearing

Many thanks
Robert Jordan
PR Retail Consultants Ltd
The Pump House,
Old Mead Road
Henham
Bishops Stortford
Herts CM22 6JG 01279 850753

Title : 6 Cardwell Terrace

Islington Borough Boundary

56
12
1096
92
100

Printed by :
RO RO

Printed at :
01-12-2014

